

SEASHELL
CONDOMINIUM ASSOC.

7

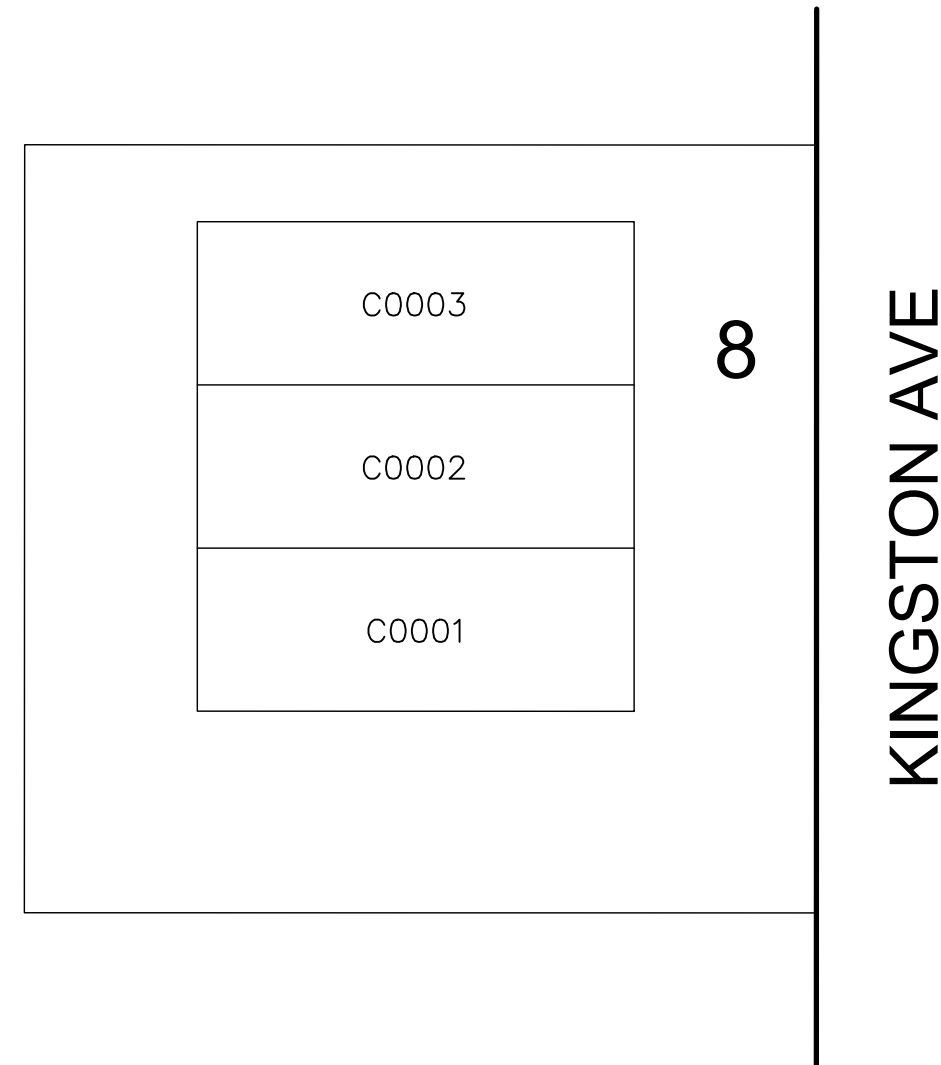

0.15 Ac± TOTAL
SCALE: 1"=20'

QUAL	UNIT TYPE	FLOOR	SQ. FT.
C0001		1	2161
C0002		1	2161
C0003		1	2161

KINGSTON AVE

8

4503 BOARDWALK
CONDOMINIUM

7

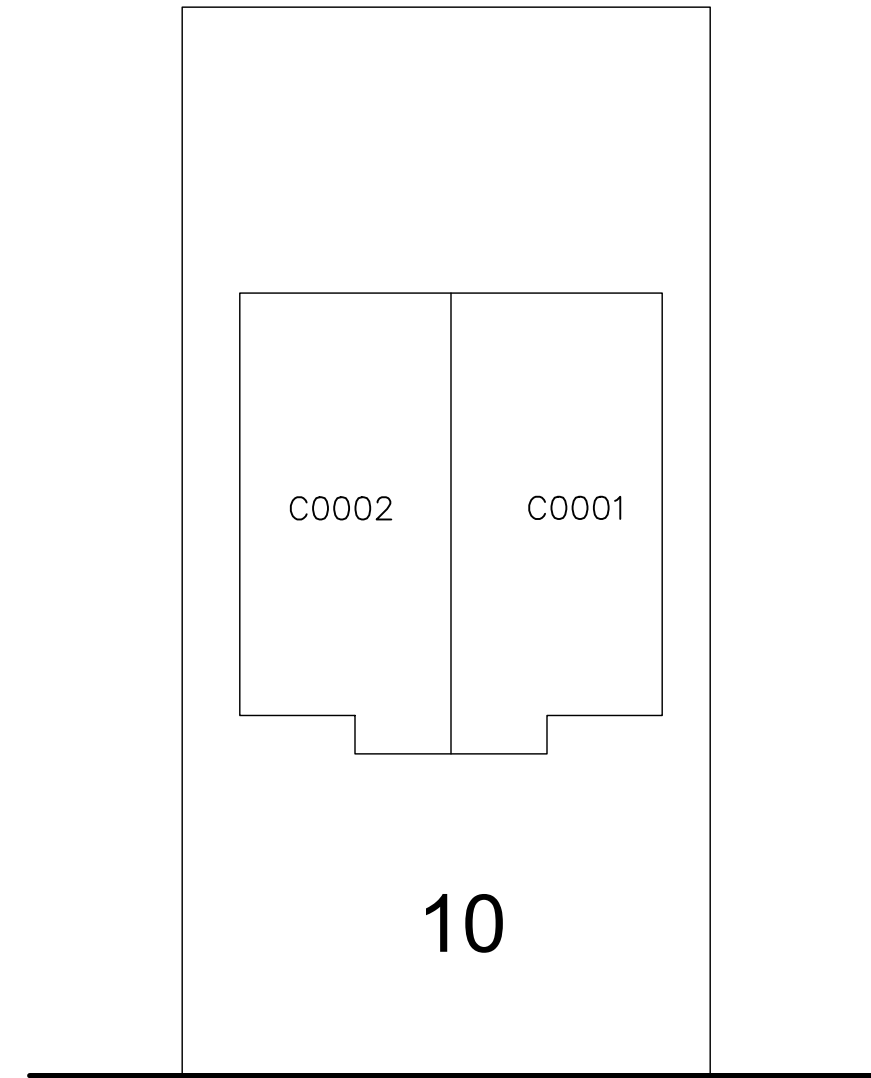

0.14 Ac± TOTAL
SCALE: 1"=20'

QUAL	UNIT TYPE	FLOOR	SQ. FT.
C0001		1	925
C0002		1	925

BOARDWALK

10

4505 BOARDWALK
CONDOMINIUM

7

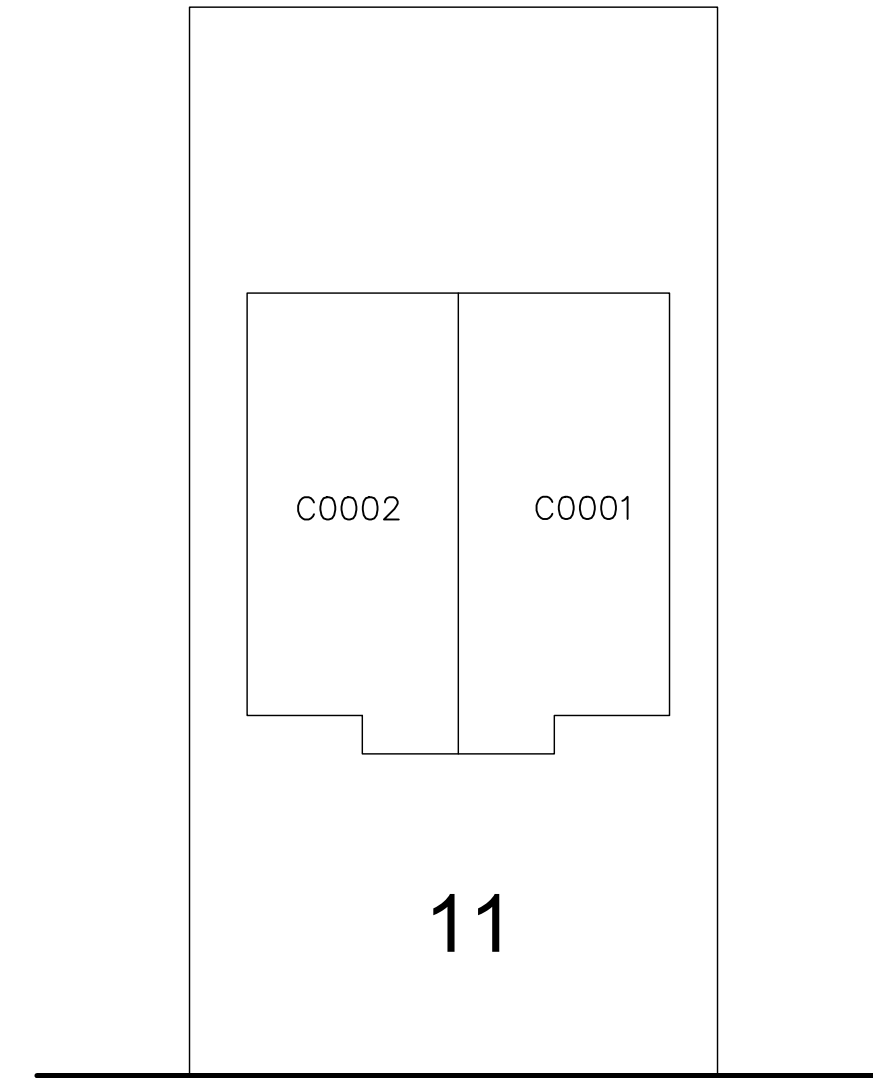

0.14 Ac± TOTAL
SCALE: 1"=20'

QUAL	UNIT TYPE	FLOOR	SQ. FT.
C0001		1	2095
C0002		1	2095

BOARDWALK

11

SANDCASTLE
CONDOMINIUM ASSOC.

7

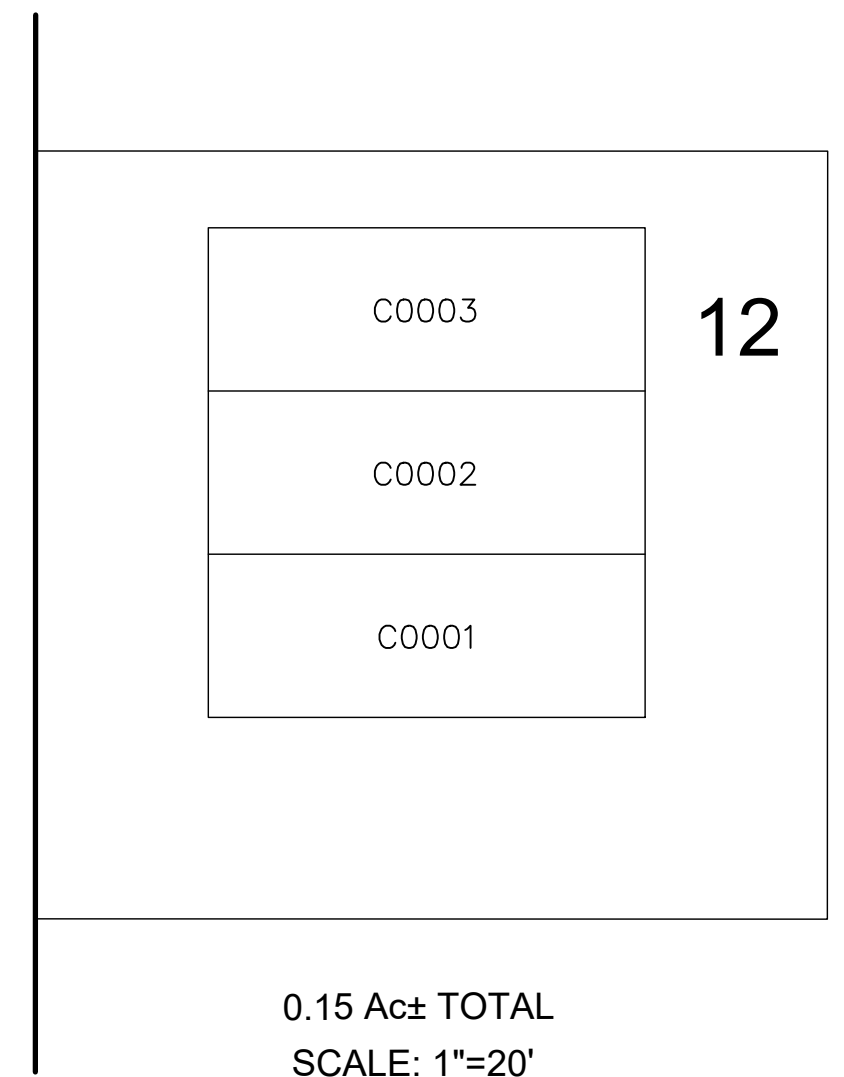

0.15 Ac± TOTAL
SCALE: 1"=20'

QUAL	UNIT TYPE	FLOOR	SQ. FT.
C0001		1	2364
C0002		1	2475
C0003		1	2443

BERKLEY SQ

12

BARTRAM ESTATES

8

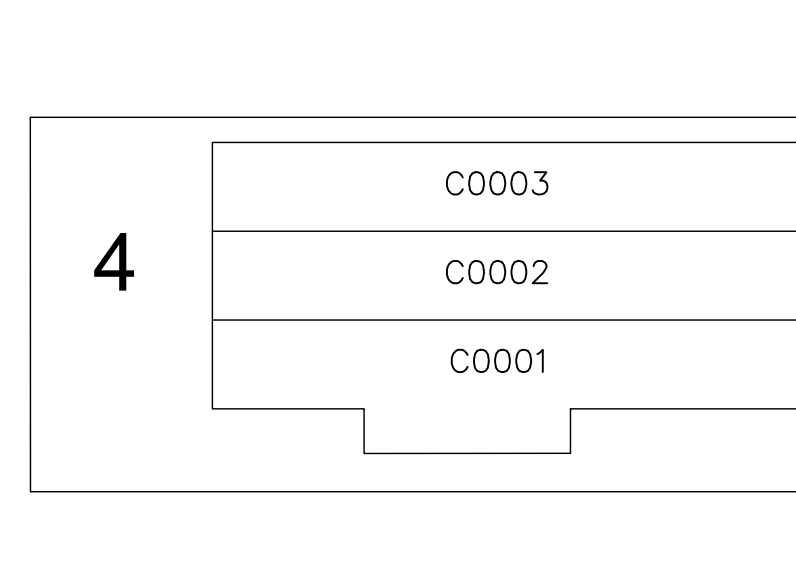

0.07 Ac± TOTAL
SCALE: 1"=20'

QUAL	UNIT TYPE	FLOOR	SQ. FT.
C0001		1	1496
C0002		2	1160
C0003		3	1160

BARTRAM PL

4

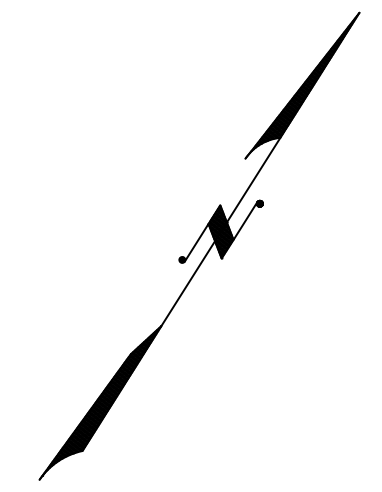

THIS SHEET HAS BEEN DRAWN USING COMPUTER AIDED DRAFTING/DESIGN (CAD/D)

REVISIONS				
DATE	BY	LIC. NO.	BLOCK	LOT

THIS MAP HAS BEEN GIVEN A FORMAL CERTIFICATION BY THE DIVISION OF TAXATION ON NOVEMBER 25, 1997, SIGNED BY WILLIAM H. BLACK, CTA AND ASSIGNED SERIAL NUMBER 778

TAX MAP
CITY OF ATLANTIC CITY
ATLANTIC COUNTY, NEW JERSEY
NOT TO SCALE
DATE: AUG 1995
JOSEPH M DOLAN, PLS, PP
MUNICIPAL LAND SURVEYOR
NEW JERSEY LICENSE NO. 23930
OFFICE OF THE CITY ENGINEER
603 CITY HALL
ATLANTIC CITY, NEW JERSEY 08401

TO SHOW CONDITIONS AS OF MAY 2019
COA# 24GA27973300